

SERVICE PARTS LIST FOR MITSUBISHI ELECTRIC PACKAGED AIR-CONDITIONERS

Series : PUHY-EP·YHM-A(-BS)
PUHY-EP·YSHM-A1(-BS)

For use with the R410A

May 2009

BWE09090

INDEX

PUHY-EP250YHM-A
PUHY-EP250YHM-A-BS

The Package name list

| | |
|-------------------------------|--|
| PUHY-EP450YSHM-A1(-BS) | [PUHY-EP200YHM-A(-BS) + PUHY-EP250YHM-A(-BS)] |
| PUHY-EP550YSHM-A1(-BS) | [PUHY-EP250YHM-A(-BS) + PUHY-EP300YHM-A(-BS)] |
| PUHY-EP750YSHM-A1(-BS) | [PUHY-EP200YHM-A(-BS) + PUHY-EP250YHM-A(-BS) + PUHY-EP300YHM-A(-BS)] |
| PUHY-EP850YSHM-A1(-BS) | [PUHY-EP250YHM-A(-BS) + PUHY-EP300YHM-A(-BS) + PUHY-EP300YHM-A(-BS)] |

PUHY-EP250YHM-A
PUHY-EP250YHM-A-BS

EXTERNAL PARTS & BLOWER PARTS

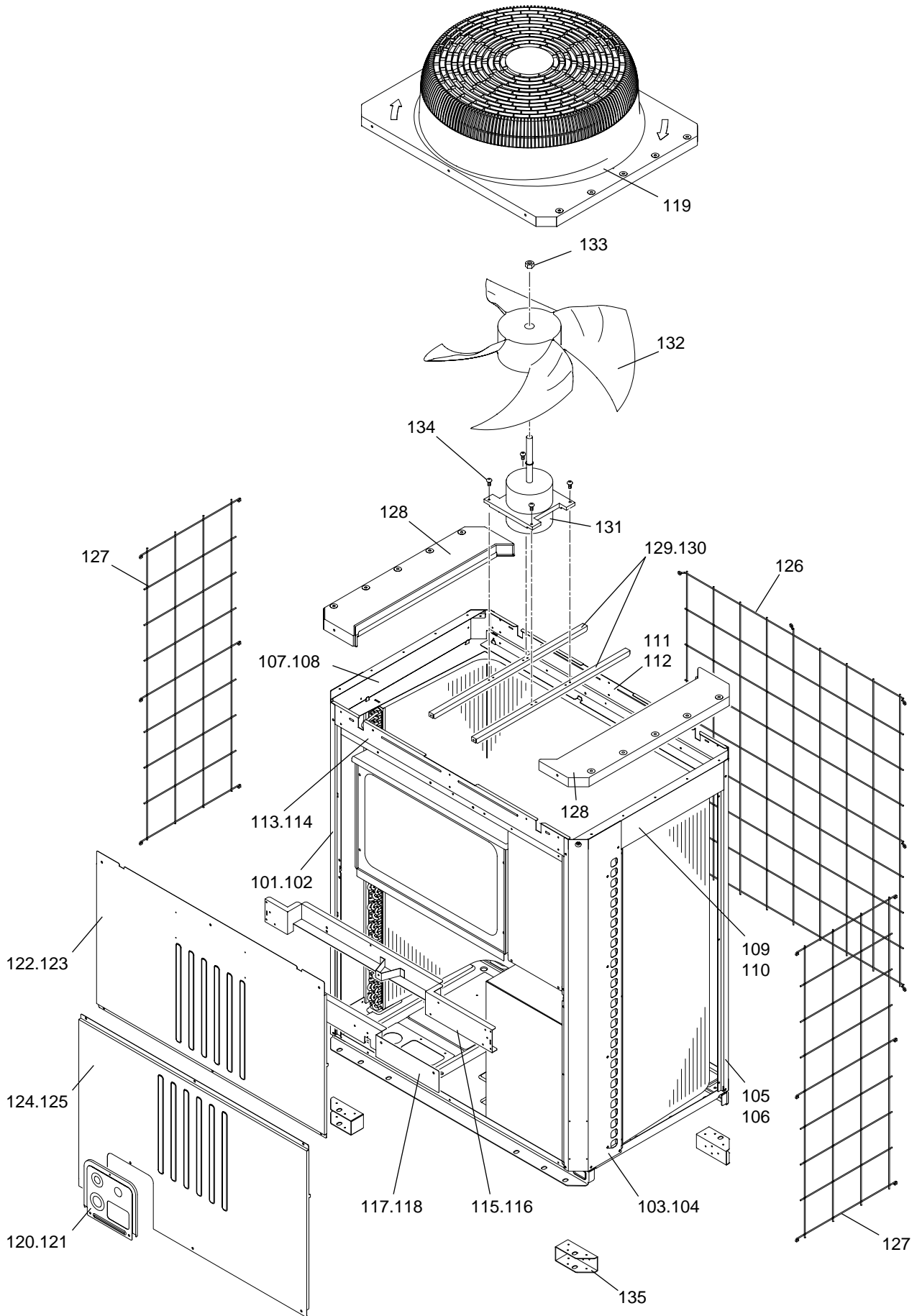

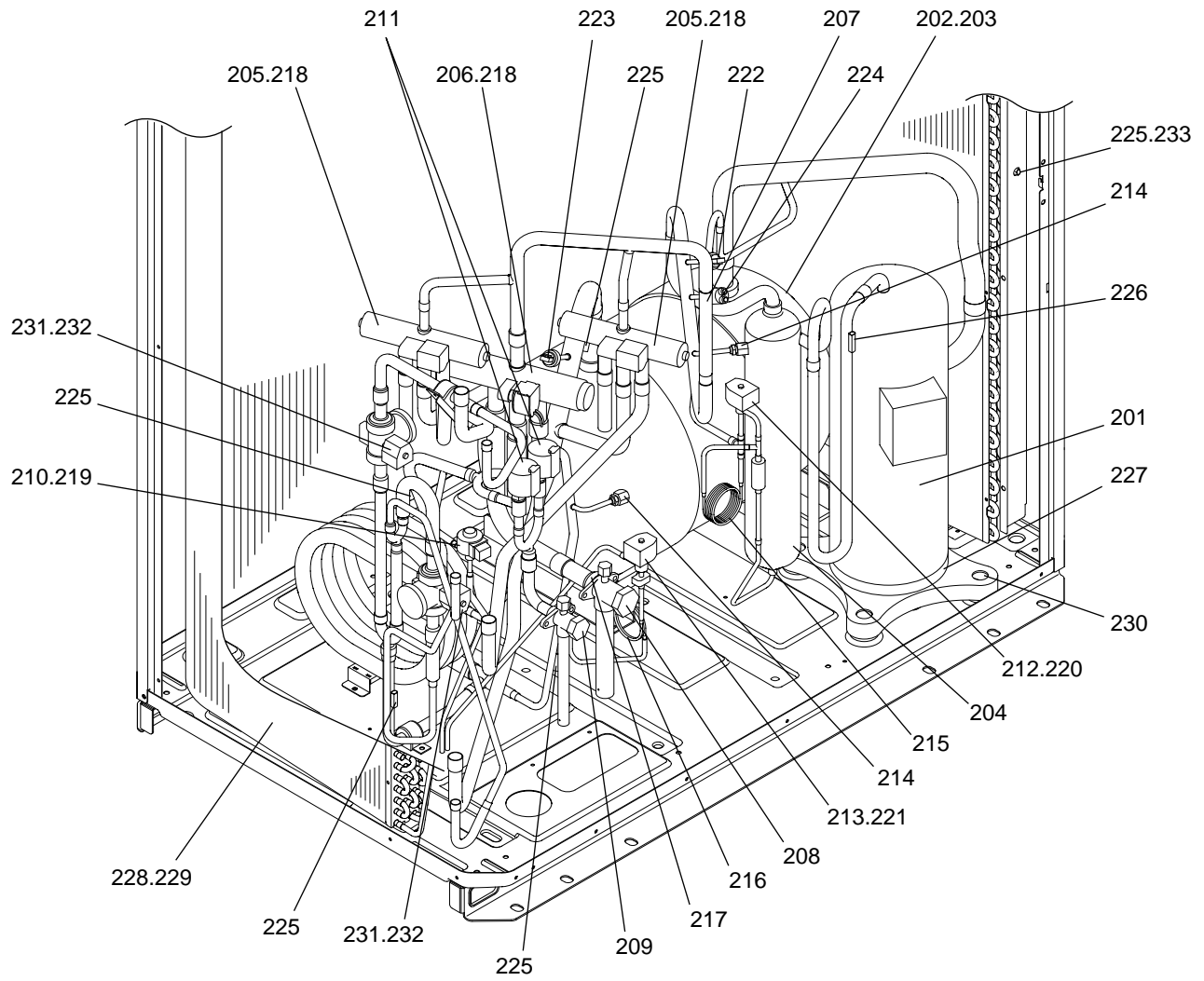

PUHY-EP250YHM-A
 PUHY-EP250YHM-A-BS

CONTROL BOX PARTS

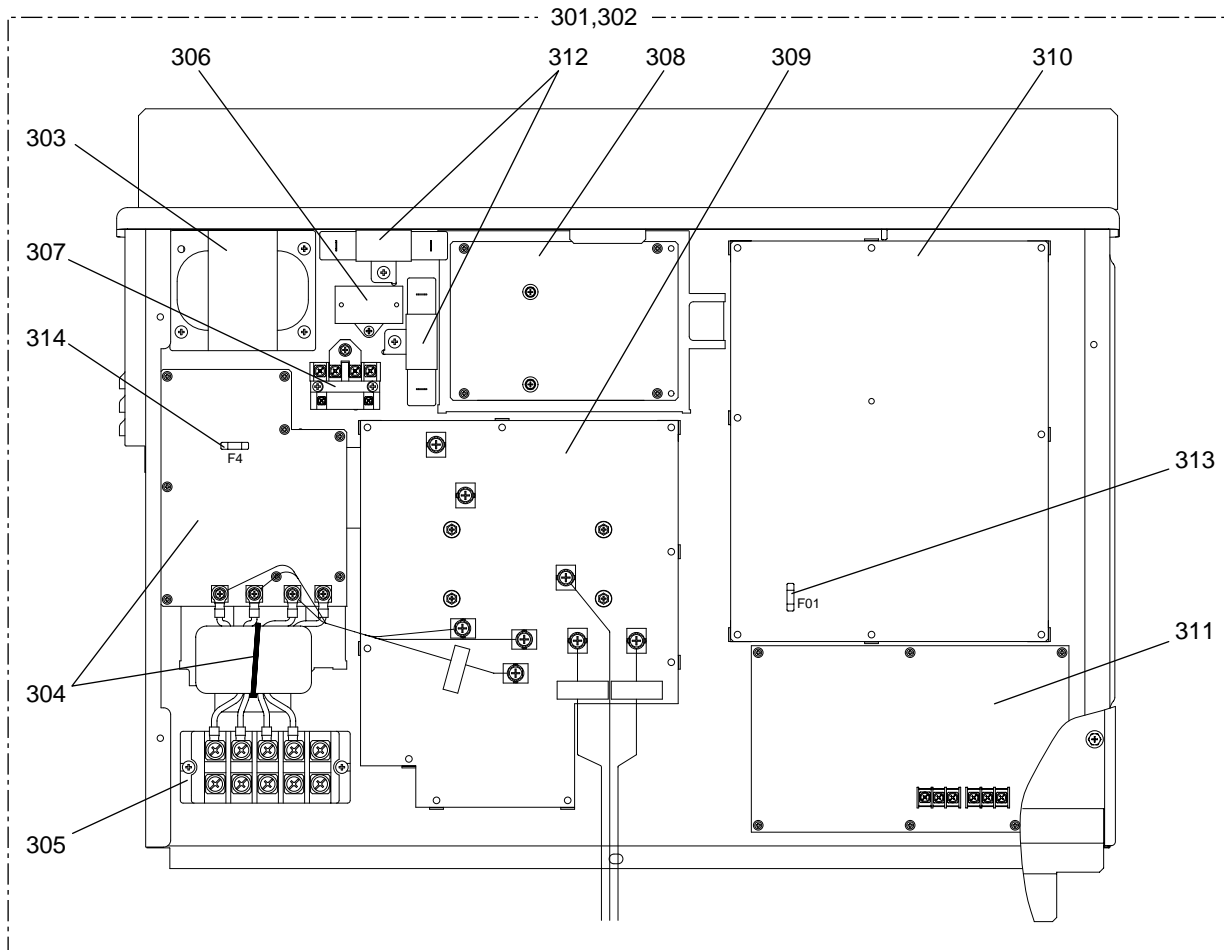

| No. | Part No. | G : RoHS Apply Only W : RoHS Apply by Running Change | | Spec. | PUHY-EP250YHM-A | PUHY-EP250YHM-A-BS | | | | Dwg. No. | Price | Revision History |
|-----|-------------|---|----------------|------------------|-----------------|--------------------|--|--|--|-------------|-------|------------------|
| | | | Part Name | | | | | | | | | |
| 301 | R61 057 305 | G | Control box | EP250YHM | 1 | | | | | KE80C152G11 | | |
| 302 | R61 058 305 | G | Control box | EP250 BS | 1 | | | | | KE80C152G12 | | |
| 303 | R61 011 259 | G | Reactor | <DCL> | 1 | 1 | | | | P715440X02 | | |
| 304 | R61 003 293 | G | Noise filter | <Noise Filter,L> | 1 | 1 | | | | KE80C155G01 | | |
| 305 | R61 007 246 | G | Terminal block | <TB1> | 1 | 1 | | | | S436005H12 | | |
| 306 | R61 001 255 | G | Capacitor assy | <C100> | 1 | 1 | | | | KE00D263G01 | | |
| 307 | R61 003 216 | G | Relay | <72C> | 1 | 1 | | | | P421295X01 | | |
| 308 | R61 037 280 | G | FAN board | | 1 | 1 | | | | W652171G07 | | |
| 309 | R61 039 280 | G | INV board | | 1 | 1 | | | | KE80C154G02 | | |
| 310 | R61 011 281 | G | Control board | | 1 | 1 | | | | KE80C153G01 | | |
| 311 | R61 012 281 | G | M-NET board | | 1 | 1 | | | | KE80C055G03 | | |
| 312 | R61 001 234 | G | Resistor | <R1>,<R5> | 2 | 2 | | | | P411151X01 | | |
| 313 | R61 005 239 | G | Fuse | 3.15A AC250V T | 1 | 1 | | | | S423001H39 | | |
| 314 | R63 993 964 | G | Fuse | 6.3A AC250V T | 1 | 1 | | | | S423001H30 | | |
| | | | | | | | | | | | | |
| | | | | | | | | | | | | |
| | | | | | | | | | | | | |
| | | | | | | | | | | | | |
| | | | | | | | | | | | | |

